

FOR LEASE ±1,500 - 14,000 Sq. Ft.

SECOND FLOOR OFFICE SPACE AT HAYDEN VIEW PLAZA



15001 N HAYDEN ROAD | SCOTTSDALE, AZ 85260

High Visibility and Excellent Signage Opportunities. Exceptional Freeway Access. Zoned C-3, City of Scottsdale.

Presented by

JOHN QUATRINI

Associate Broker

C 602 859 0506

john@shellcommercial.com

SUZANNE ENRIGHT

Senior Associate

C 602 471 2981

suzanne@shellcommercial.com

Shell Commercial Investment Real Estate

O 480 443 3992

F 480 443 3680

www.shellcommercial.com

16410 N 91st Street | Suite 112 | Scottsdale, AZ 85260

The above is subject to prior sales and leasing. This information has been secured from sources we believe to be reliable, but we make no representation or warranties, expressed or implied as to the accuracy of this information.

15001 N Hayden Road | Scottsdale, Arizona 85260



JOHN QUATRINI
Associate Broker
C 602 859 0506
john@shellcommercial.com

SUZANNE ENRIGHT
Senior Associate
C 602 471 2981
suzanne@shellcommercial.com



The above is subject to prior sales and leasing. This information has been secured from sources we believe to be reliable, but we make no representation or warranties, expressed or implied as to the accuracy of this information.

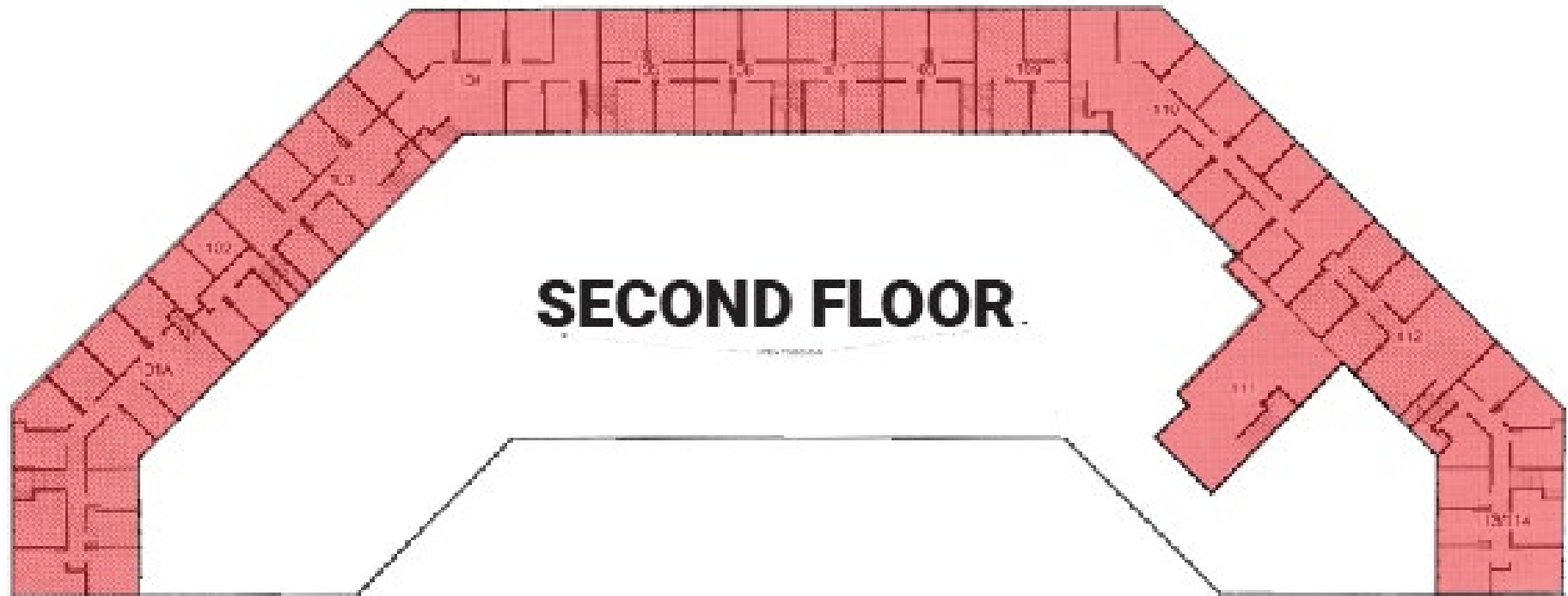

NOT TO SCALE

All information furnished regarding property for sale, rental or financing is from sources deemed reliable, but no warranty or representation is made to the accuracy thereof and same is submitted to errors, omissions, change of price, rental or other conditions, prior to sale, lease or financing or withdrawal without notice. No liability of any kind is to be imposed on the broker herein. This information has been secured from sources deemed reliable, however, we make no warranties as to its accuracy.