

OFFICE SPACE FOR LEASE

±2,260 SF OFFICE CONDOMINIUM

**NEWLY
REMODELED!**

PROPERTY HIGHLIGHTS

- Reception, Conference Room, Five (5) Offices
- Bull Pen, Break Room, Utility Room
- VCT "Wood Plank" Flooring
- Bright, light, open "feel"

10609 N HAYDEN ROAD | SUITE 108 | SCOTTSDALE, ARIZONA 85260



John Quatrini
Associate Broker
C 602 859 0506

john@shellcommercial.com



Suzanne Enright
Senior Associate
C 602 471 2981

suzanne@shellcommercial.com

shellcommercial.com



IDEAL OFFICE SETTING

10609 N HAYDEN ROAD | SUITE 108 | SCOTTSDALE, ARIZONA 85260



The above is subject to prior sales and leasing. This information has been secured from sources we believe to be reliable, but we make no representation or warranties, expressed or implied as to the accuracy of this information.

FLOOR PLAN

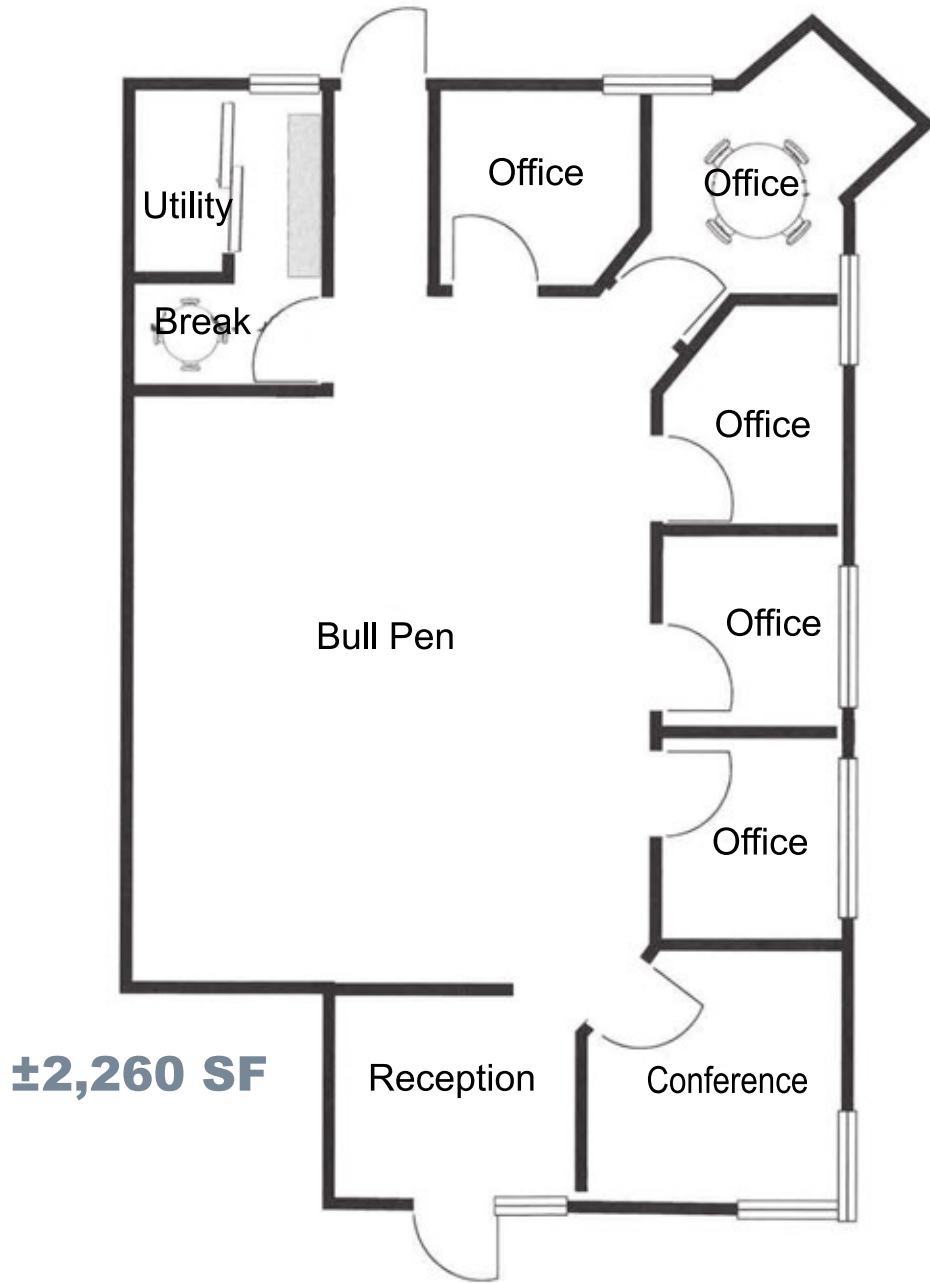

PERFECT LOCATION!



MINUTES FROM LOOP 101

NOT TO SCALE

All information furnished regarding property for sale, rental or financing is from sources deemed reliable, but no warranty or representation is made to the accuracy thereof and same is submitted to errors, omissions, change of price, rental or other conditions, prior to sale, lease or financing or withdrawal without notice. No liability of any kind is to be imposed on the broker herein. This information has been secured from sources deemed reliable, however, we make no warranties as to its accuracy.